

Porsche 911 EXTREME

Instruction Manual

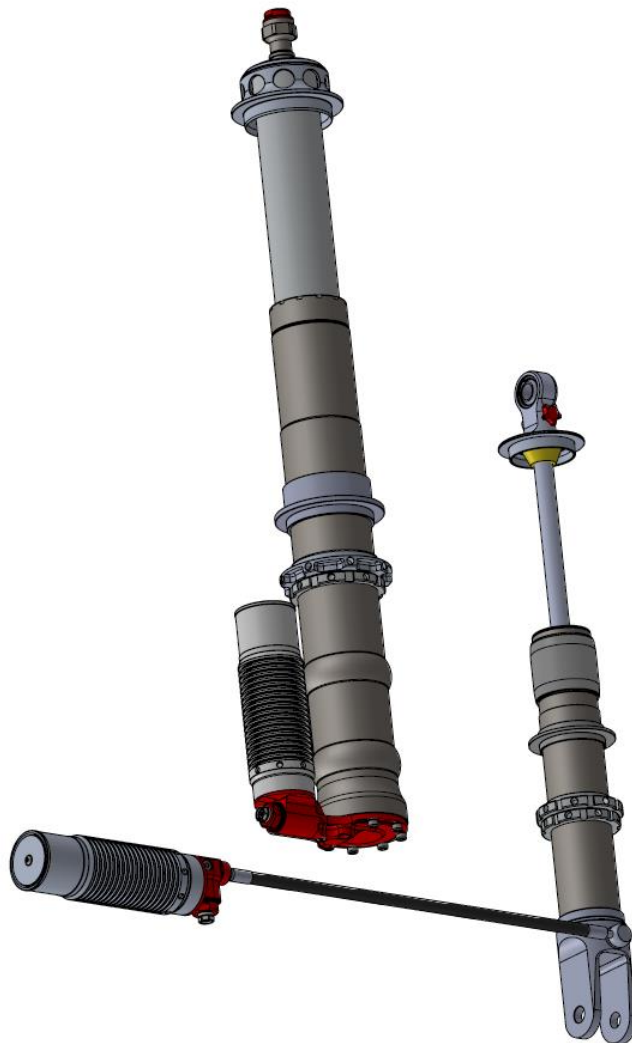

Front: AA-POR-0087-7

Rear: AA-POR-0087-8

[IM]-PKM-PORSCHE-911-EXTREME

14/11/2024



Porsche 911 EXTREME : Instruction Manual



Table of contents

Chapt I :	Specification	3
Chapt II :	Assembly	3
1.	Front damper	3
2.	Rear damper	7
Chapt III :	Warnings	9
Chapt IV :	Services.....	10
Chapt V :	Versioning.....	11
Chapt VI :	Notes	12

Chapt I : **Specification**

This damper kit is specially developed for the Porsche 911 EXTREME.

Front damper:

Monotube cartridge with a $\varnothing 44$ mm piston ($\varnothing 49$ mm alloy tube).
The damper come with bump stop, a spring and a helper spring.

Rear damper:

Monotube cartridge with a $\varnothing 46$ mm piston ($\varnothing 50$ mm alloy tube).
The damper come with bump stop and spring, no helper spring.

This is 3 ways setting damper kit: **Rebound**, **High Speed Bump** and **Low Speed Bump**. These 3 setting ways are completely independent.

Chapt II : **Assembly**

1. Front damper

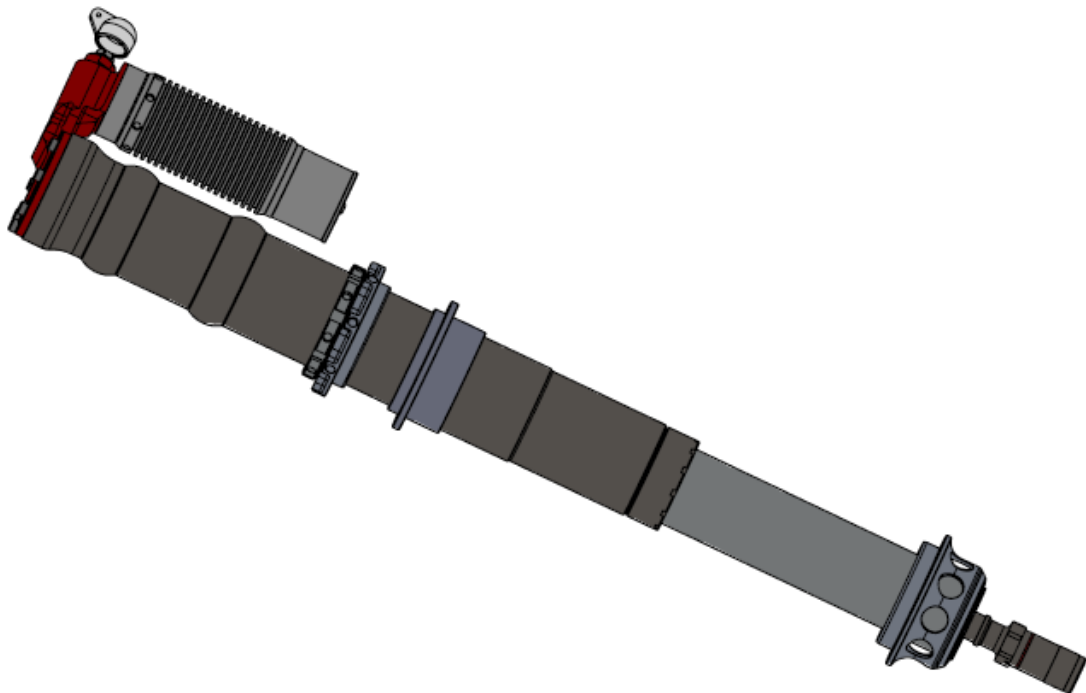

The front damper assembly is composed of an insert and a strut. Damper assembly can be purchased without the strut.

The inside of the strut is protected by a wiper seal. To protect the seal during assembly it must be greased. The bushings in the strut must also be greased.

Mounting insert in the strut:

The following procedure will explain how to assemble the damper with the strut, step by step.

Step 1: Insert the damper by the rod side in the strut by the side with screw holes.

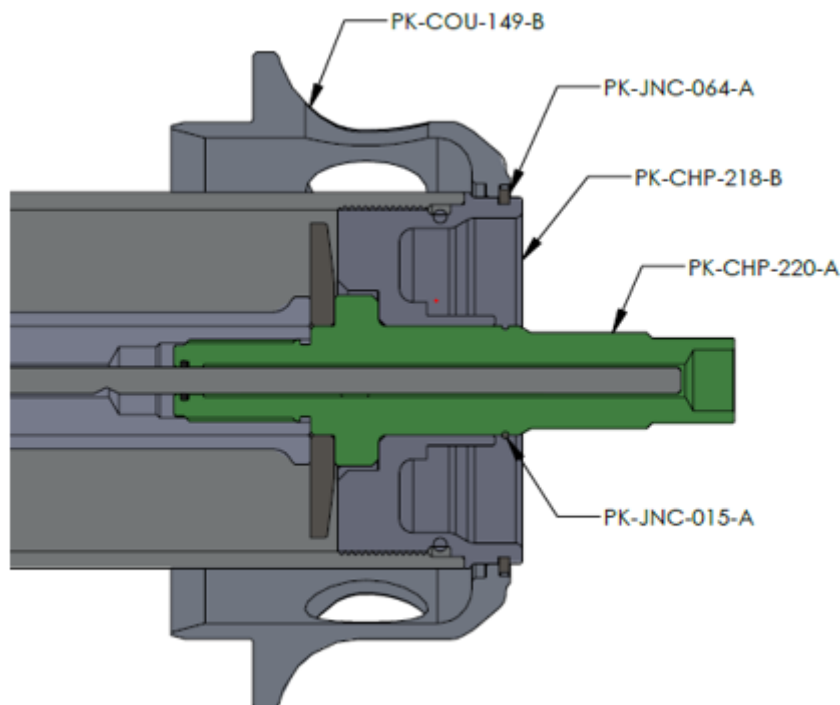

Step 2: On the other side, be careful to turn the rod to align the PK-CHP-218-B and the PK-CHP-220-A on the 2 parallel plates. Then, lock the rod with the PK-JNC-015-A. Install the transportation cap : OT-BOU-025-A.

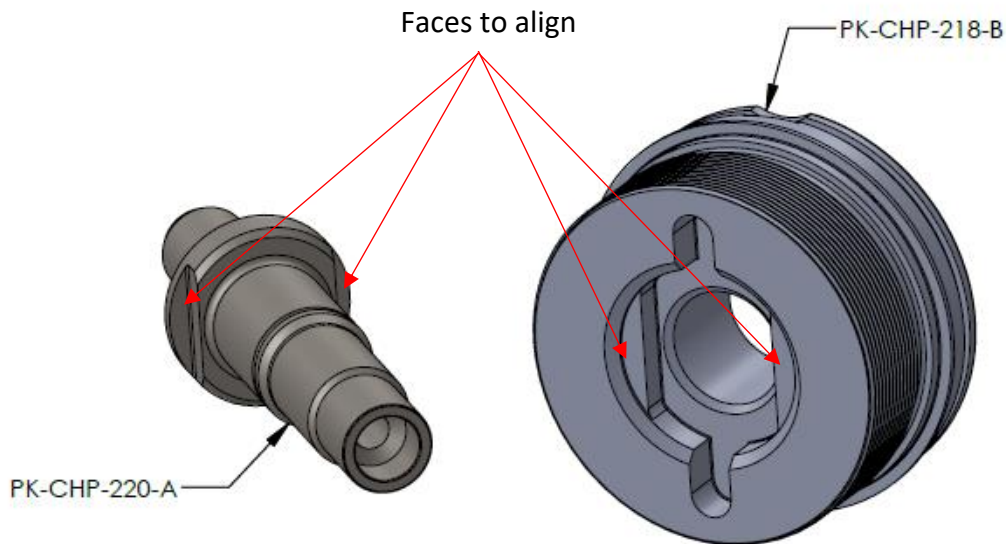

Step 3: Align the holes from the red body in front of the one of the strut and put the screw inside with the washer. Before you put the screw, insert 70 ml of oil (PK-OIL-001-A) in the space between the tube and the strut (red arrow on the image). Be careful to put the 2 longest screws on the upper side, on the reservoir side. Screw them with Loctite 270 at 6 Nm of torque.

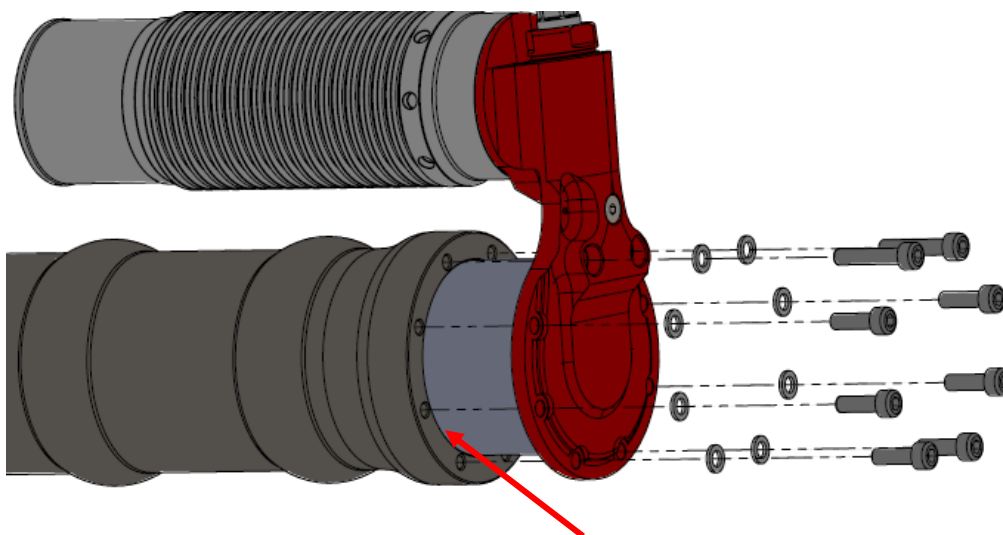

Step 4: Put the springs around the strut, and place the cup holder PK-COU-149-B in place, before locking it with the PK-JNC-064-A.

Step 5: After installing the damper in the car by locking it with the ASS-MOD-002-A, be sure to adjust your clicks again.

Setting procedures:



Rebound Adjuster

Type of adjuster : adjustable bleed

Identification: 3 mm BTR slot at the top

Number of positions: approx. 30

Click position 0 : Fully clockwise at maximum force.

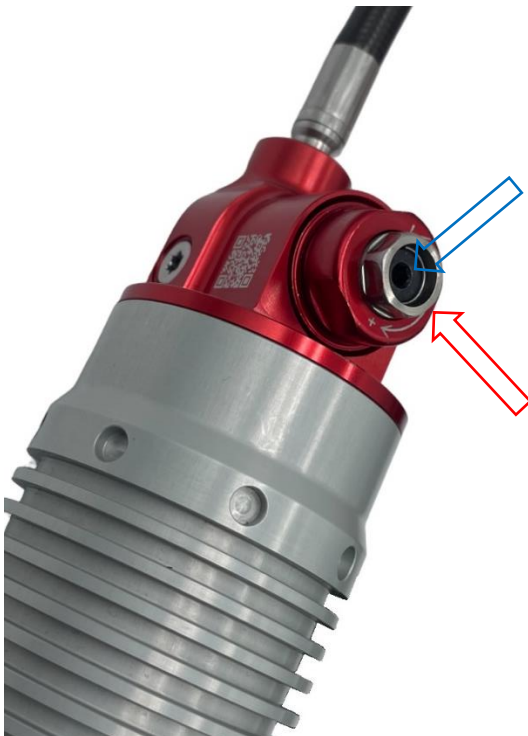

Low Speed Bump Damping Adjuster (blue arrow)

Type of adjuster : adjustable bleed

Identification : The black screw with an internal 3 mm hex

Number of positions : 33

Click position 0 : Fully clockwise at maximum force.

High Speed Bump Damping Adjuster (red arrow)

Type of adjuster : spring preload

Identification : The grey screw with an external 12 mm hex

Number of position : 49

Click position 0 : Fully clockwise at maximum force.

2. Rear damper

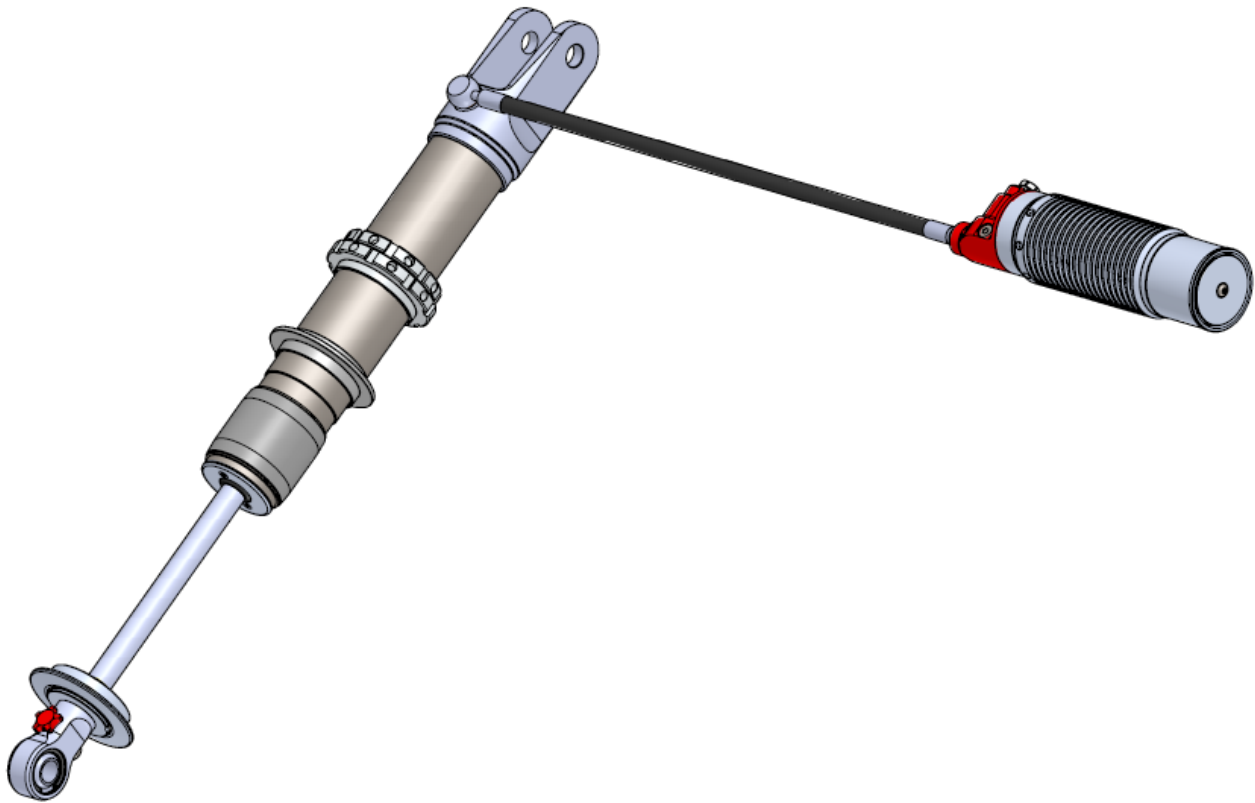

The rear damper doesn't need strut. Damper fit in the car by ball joint.

Setting procedures:

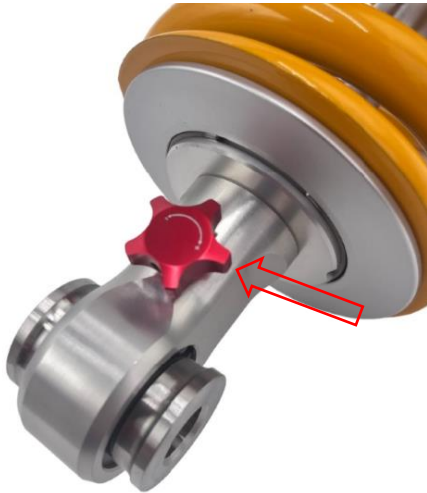

Rebound Adjuster

Type of adjuster : adjustable wheel

Identification: Red wheel (hand screwable)

Number of positions: 30

Click position 0: Fully clockwise at maximum force.

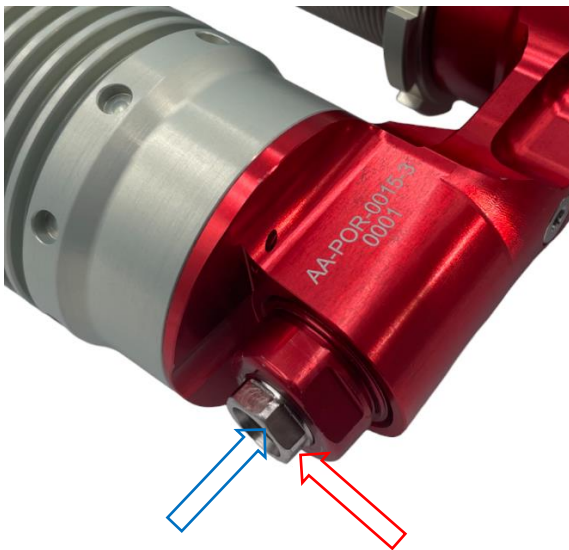

Low Speed Bump Damping Adjuster (blue arrow)

Type of adjuster : adjustable bleed

Identification : The black screw with an internal 3 mm hex

Number of positions : 33

Click position 0 : Fully clockwise at maximum force.

High Speed Bump Damping Adjuster (red arrow)

Type of adjuster : spring preload

Identification : The grey screw with an external 12 mm hex

Number of position : 49

Click position 0 : Fully clockwise at maximum force.

Chapt III : **Warnings**

- Dampers are an important part of the car and can affect the handling and stability of the vehicle.
- PKM Consulting cannot be held responsible for damage on the vehicle or injuries if instructions and maintenance are not fully respected.
- Test the car at low speed first after installing the product.
- For any anormal comportment of the car or the product, stop the vehicle immediately and fix the problem.
- Clean your damper after every use with adapted products.
- You must not touch the inflate screw at the opposite side of the adjustment wheel, it could depressurize your damper and severely affect its functioning.



Porsche 911 EXTREME : Instruction Manual



Chapt IV : Services

Services must be done every 900km or every year.

PKM Consulting
428, Avenue de Copenhague
83870 Signes, France

+33494903487 or contact@pkm-consulting.com

Chapt V : **Versioning**

REV	NAME	DATE	CHANGES
A	ETTORI	02/03/2023	Creation
B	KOLLEN	09/09/2024	Update



Porsche 911 EXTREME : Instruction Manual



Chapt VI : Notes

.....

.....

.....

.....

.....

.....

.....

.....

.....

.....

.....

.....

.....

.....

.....

.....

.....

.....

.....

.....

.....